

FSMMD

Optimal for multi-shift operation.



The FSMMD operator chair system was specially developed for applications with the highest demands in ergonomics and adjustment options. Its wide adjustment ranges for the seat and consoles allow the operator to work in sitting or standing positions. Seat and console adjustment positions can be easily saved by the operator using the standard integrated memory function.

The expansive memory storage allows 30 operators to save 5 desired positions each. The specially designed consoles can fit a variety of joysticks and pilot devices to meet the needs of a range of applications. Delivered with blank consoles or completely wired with built-in control devices, this operator chair system is particularly suited to the high demands of 3-shift operation.

Basic version Chair System Base

Adjustments:

Seat position

Electric system height adjustment
Mechanical seat slide forward & back

Consoles

Electrical height, length and tilt adjustment
Additional mechanical slide forward & back
Mechanically swiveling inwards
Mechanically adjustable armrest

Footrests

Electrical height adjustment
Electric tilt adjustment
Mechanically tiltable and foldable bull horns (optional)

Rotary motion

Electrical system rotation +/- 120°

Consoles

Customizable consoles supplied with joysticks and pilot devices or blank
Includes manually adjustable armrests
For dimensions see Page 7

Seat

Available with cloth or leather Koenig seat with U-Cut or full seat cushion.
2-point retractable seat belt or 4-point shoulder harness also available

Suspension

Pneumatic suspension with integrated compressor (24 VDC)

Dimensions Adjustment Range

Chair system see Page 4	Mounting holes see Page 5
Consoles see Page 7	Monitor mounting, standing operation see Page 6

Electric

Rocker switches for electrical adjustability
Memory control for electric seat height, consoles, footrest adjustment and system rotation. Memory functionality allows for a maximum of 30 operators. 5 adjustment positions can be saved per operator. Control switches built into the right console.
Electrical connection: 24 VDC - 20 A and 230 VAC

Options

Electrical chair system slide
Travel range +/- 7.87 in. (200 mm)

Joysticks and pilot devices

Internal electrical wiring of command devices on terminal block

Extended consoles on the front for monitor installation

Monitor attachment via side monitor arm with mechanical swiveling

Montagebohrungen (mounting holes)

elektrischer Verfahrerschlitten (+-200mm)
(motorized sliding system)

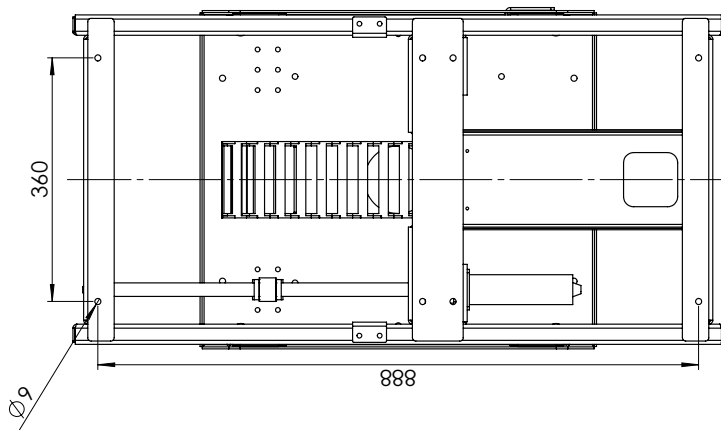

elektrischer Drehkranz ($\pm 120^\circ$)
(motorized swing bearing)

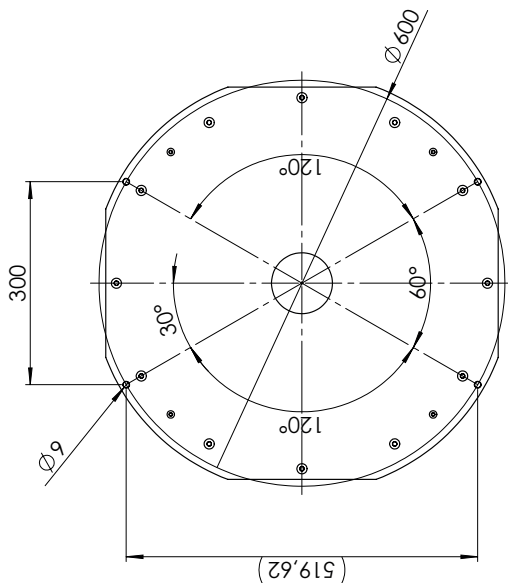

Für die Montage M8 (8.8) Schrauben mit einem Anziehdrehmoment von 24Nm verwenden
(for mounting use M8 (8.8) screws with torque of 24Nm)

Rev

